

Riddhi Siddhi  
Park



## INTRODUCTION

*Live life unplugged*

*Experience unrestrained comfort at Riddhi Siddhi Park*

How often have you been knocked upon by the thought of seeking solace? How about finding a recluse that would comfort the harshness of city life, yet making you stay in closest proximity to your urban needs?

Migrate to Riddhi Siddhi Park. A utopia that connects your vivid imagination of a peaceful repose with the fast access to the metropolitan activities.

Your little where the freshness of nature invigorates your body and mind. Welcome to a haven that's your very own. It comes replete with the latest amenities at a location that just couldn't be any better.

## **AMENITIES**

- ▶ Schools and hospitals nearby.
- ▶ AC community hall extending out to garden.
- ▶ Common roof.
- ▶ Gymnasium and Yoga room.
- ▶ Guestroom with attached toilet.
- ▶ Fully ceramic tiles Flooring/Drawing & Dining/Bedroom/Floor tiles in Bedroom & Kitchen.
- ▶ Modern elevation.
- ▶ Elevators.
- ▶ Well decorated lobby with vitrified/ceramic tiles/marble.
- ▶ Full marble in staircase with railing.

## **Other features**

- ▶ 24 hour water supply.
- ▶ Generator to supplement the power supply.
- ▶ Housing finance available from leading banks.
- ▶ Telephone and T.V. points in every flat.
- ▶ Car parking.
- ▶ Intercom.
- ▶ Visitor's car parking.

## **SPECIFICATION**

- ▶ **Doors:**  
Good quality flush doors.
- ▶ **Windows:**  
Quality aluminium sliding windows.
- ▶ **Flooring:**  
Drawing/Dining, Bedroom, Kitchen & Toilets with hi-quality ceramic tiles.
- ▶ **Bathroom:**  
Ceramic tiles on walls upto door height, good quality white sanitary wares, concealed plumbing with CP fittings.
- ▶ **Kitchen:**  
Kitchen with 2' dado of ceramic tiles above worktop platform made of green marble with stainless steel sink.
- ▶ **Internal wall:**  
Plaster of Paris.
- ▶ **Electrical:**  
Concealed copper wiring with good quality switches, adequate light/fan points, provision for T.V. & Telephone points & A.C. points.

## LOCATION

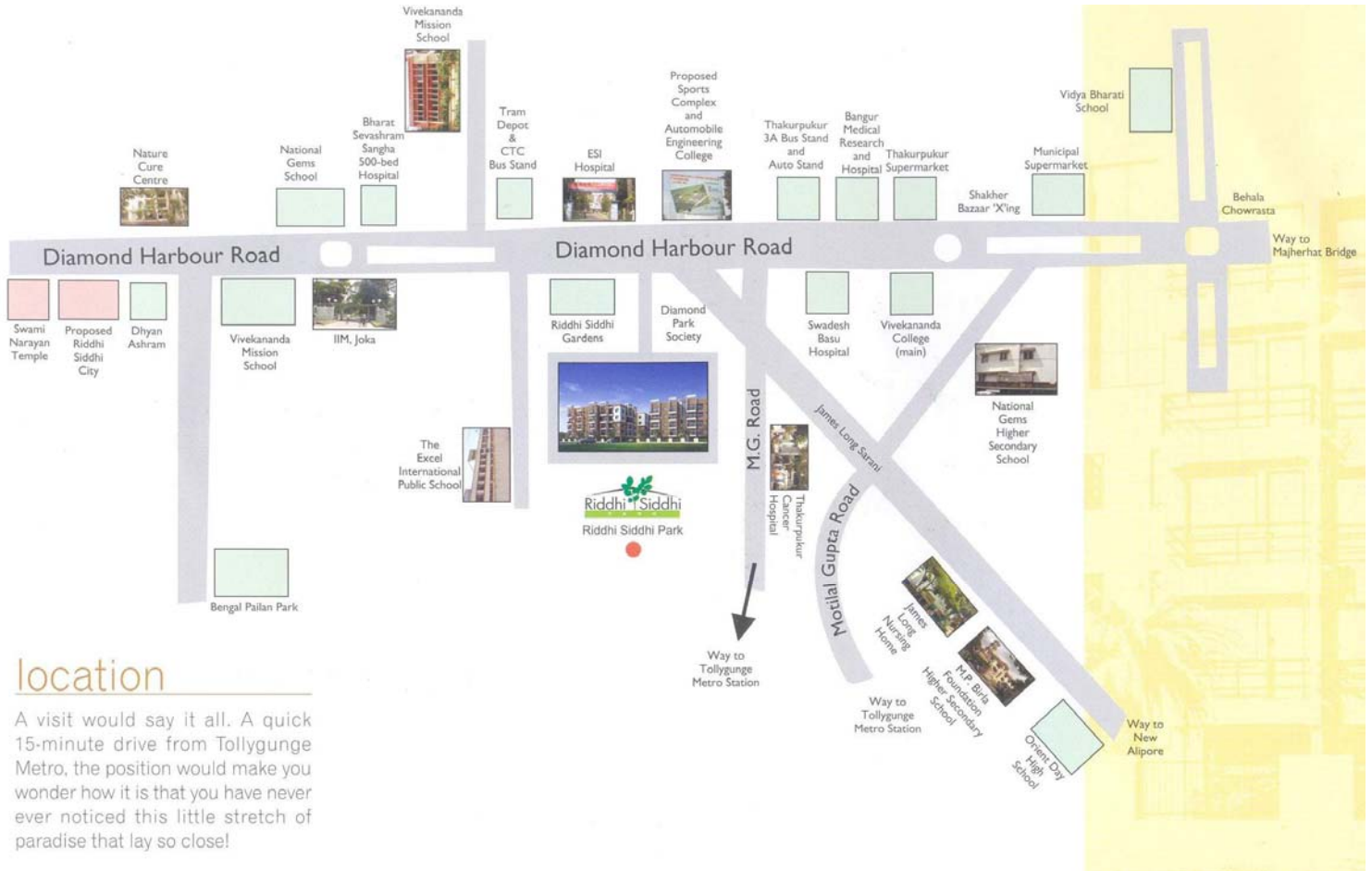

## location

A visit would say it all. A quick 15-minute drive from Tollygunge Metro, the position would make you wonder how it is that you have never ever noticed this little stretch of paradise that lay so close!

## CONNECTIVITY

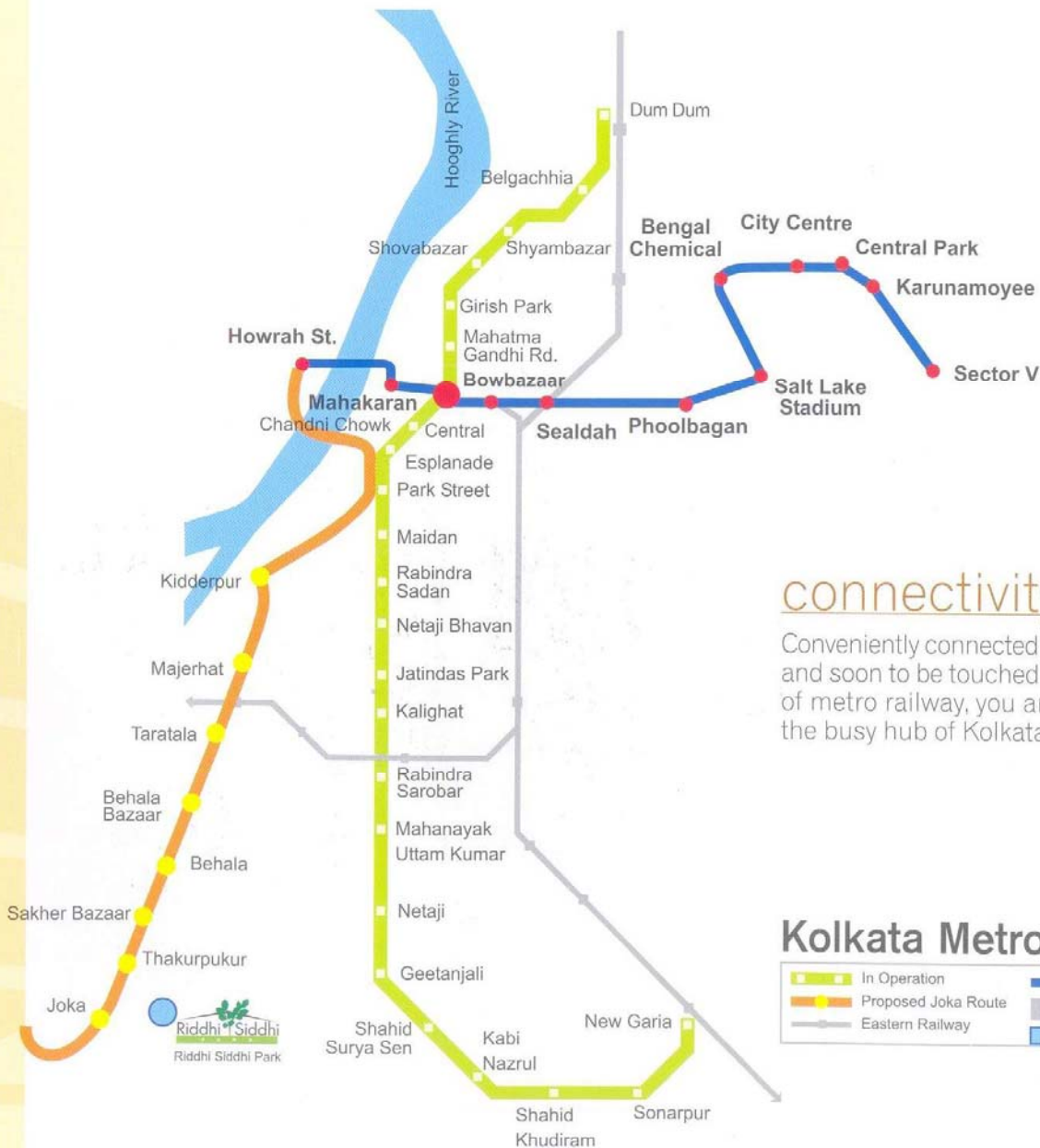

## connectivity

Conveniently connected by newly constructed roads and soon to be touched by the proposed new route of metro railway, you are just minutes away from the busy hub of Kolkata.

## Kolkata Metro Railway

In Operation	Proposed East-West Line (13kms)
Proposed Joka Route	Depot (40 acre)
Eastern Railway	Riddhi Siddhi Park



## MASTER PLAN

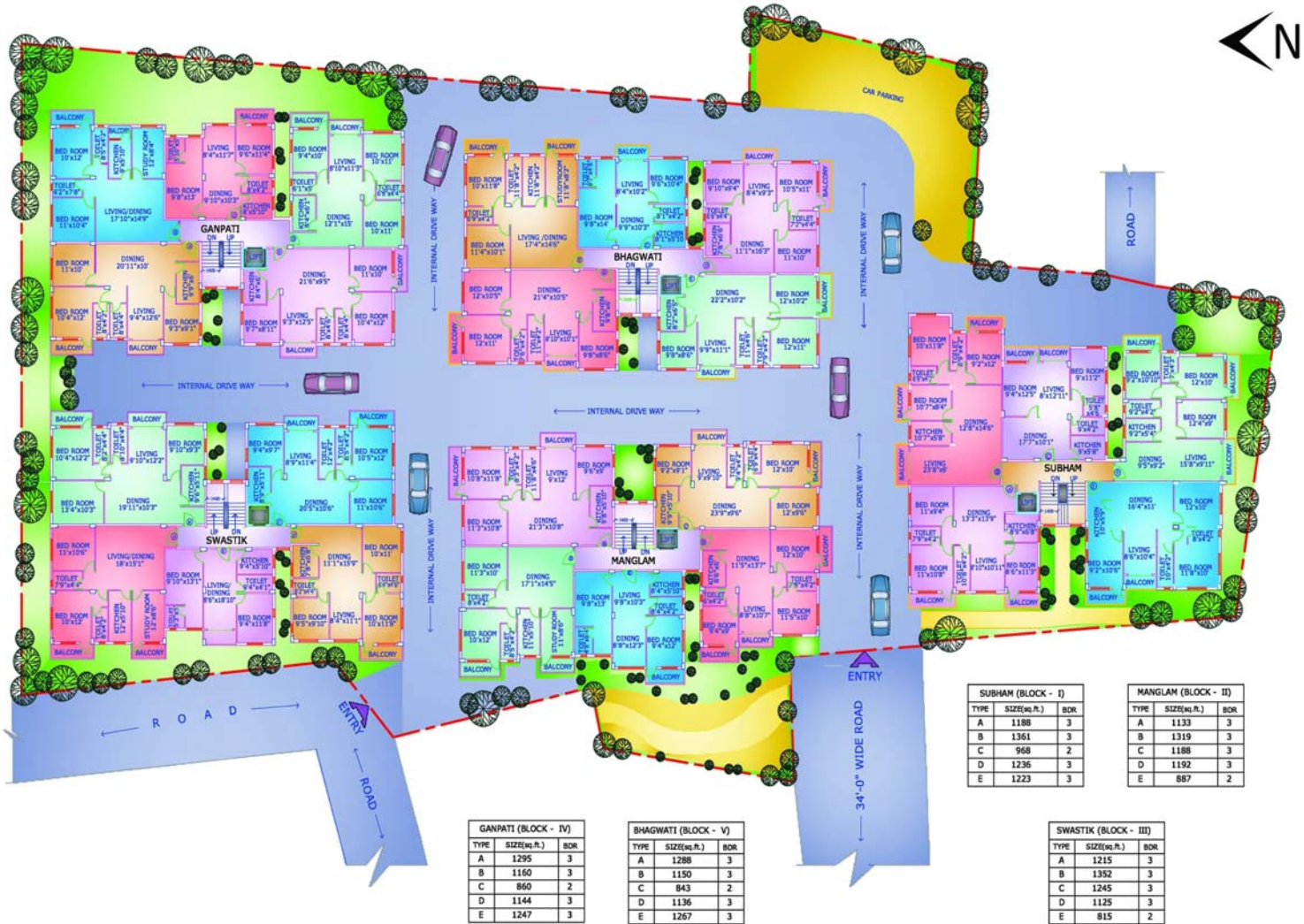

**TYPE & AREA**

**Block- I**





**Block- II**



PROJECT AT : DIAMOND PARK, THAKURPUKUR	MANGLAM (BLOCK - II)	TYPE	SIZE(sq.ft.)	BDR		DRAWN BY - SHAWOLEE ROY	<b>M/S A.CHATTERJEE &amp; ASSOCIATES</b> CONSULTING ARCHITECT & TOWNPLANNER P - 139, LAKE RD, KOLKATA - 700 029 PH- 24646079, 24654690 (M) - 9831197456
		A	1133	3			
		B	1319	3			
		C	1188	3			
		D	1192	3			
		E	887	2		SCALE 1:100	09.10.10



**Block- III**



PROJECT AT :  
DIAMOND PARK, THAKURPUKUR

SWASTIK (BLOCK - III)

TYPE	SIZE(sq.ft.)	BDR
A	1215	3
B	1352	3
C	1245	3
D	1125	3
E	815	2



DRAWN BY -  
SHAWOLEE ROY

SCALE 1:100 09.10.10

**M/S A.CHATTERJEE & ASSOCIATES**  
CONSULTING ARCHITECT & TOWNPLANNER  
P - 139, LAKE RD, KOLKATA - 700 029  
PH - 24646079, 24654690 (M) - 9831197456

**Block- IV**



PROJECT AT :  
DIAMOND PARK, THAKURPUKUR

GANPATI (BLOCK - IV)

TYPE	SIZE(sq.ft.)	BDR
A	1295	3
B	1160	3
C	860	2
D	1144	3
E	1247	3



DRAWN BY -  
SHAWOLEE ROY

SCALE 1:100 09.10.10

**M/S A.CHATTERJEE & ASSOCIATES**  
CONSULTING ARCHITECT & TOWNPLANNER  
P - 139, LAKE RD, KOLKATA - 700 029  
PH - 24646079, 24654690 (M) - 9831197456



**Block- V**



PROJECT AT :  
DIAMOND PARK, THAKURPUKUR

BHAGWATI (BLOCK - V)

TYPE	SIZE(sq.ft.)	BDR
A	1288	3
B	1150	3
C	843	2
D	1136	3
E	1267	3



DRAWN BY -  
SHAWOLEE ROY

SCALE 1:100 09.10.10

**M/S A.CHATTERJEE & ASSOCIATES**  
CONSULTING ARCHITECT & TOWNPLANNER  
P - 139, LAKE RD, KOLKATA - 700 029  
PH- 24646079, 24654690 (M) - 9831197456





## **DEVELOPER**

### **Suniram Tower Pvt. Ltd.**

Riddhi Siddhi Group is one of the leading promoters with rich experience and expertise in the construction and real estate development industry for over three decades.

The company is the trusted name behind successfully executed projects like 'Riddhi Siddhi Garden' at Diamond Harbour Road, 'Riddhi Siddhi Mansion at Moore Avenue, 'Riddhi Siddhi Villa at Dover Lane, 'Riddhi Siddhi View at NSC Bose Road, Kol- 40, 'Ballygunge Chambers' at Hazra Road and many more.

Riddhi Siddhi has also gone beyond to establish remarkable ventures in Delhi, Bangalore and Siliguri. Other upcoming projects include a mega complex of five lakh square feet named 'Riddhi Siddhi City at Joka.

At Riddhi Siddhi, we don't just shelter your dreams but nurture your aspirations too.

## **ARCHITECT**

### **Arup Chatterjee**